

HWLING HS-198F Solar Stand Fan

Manual

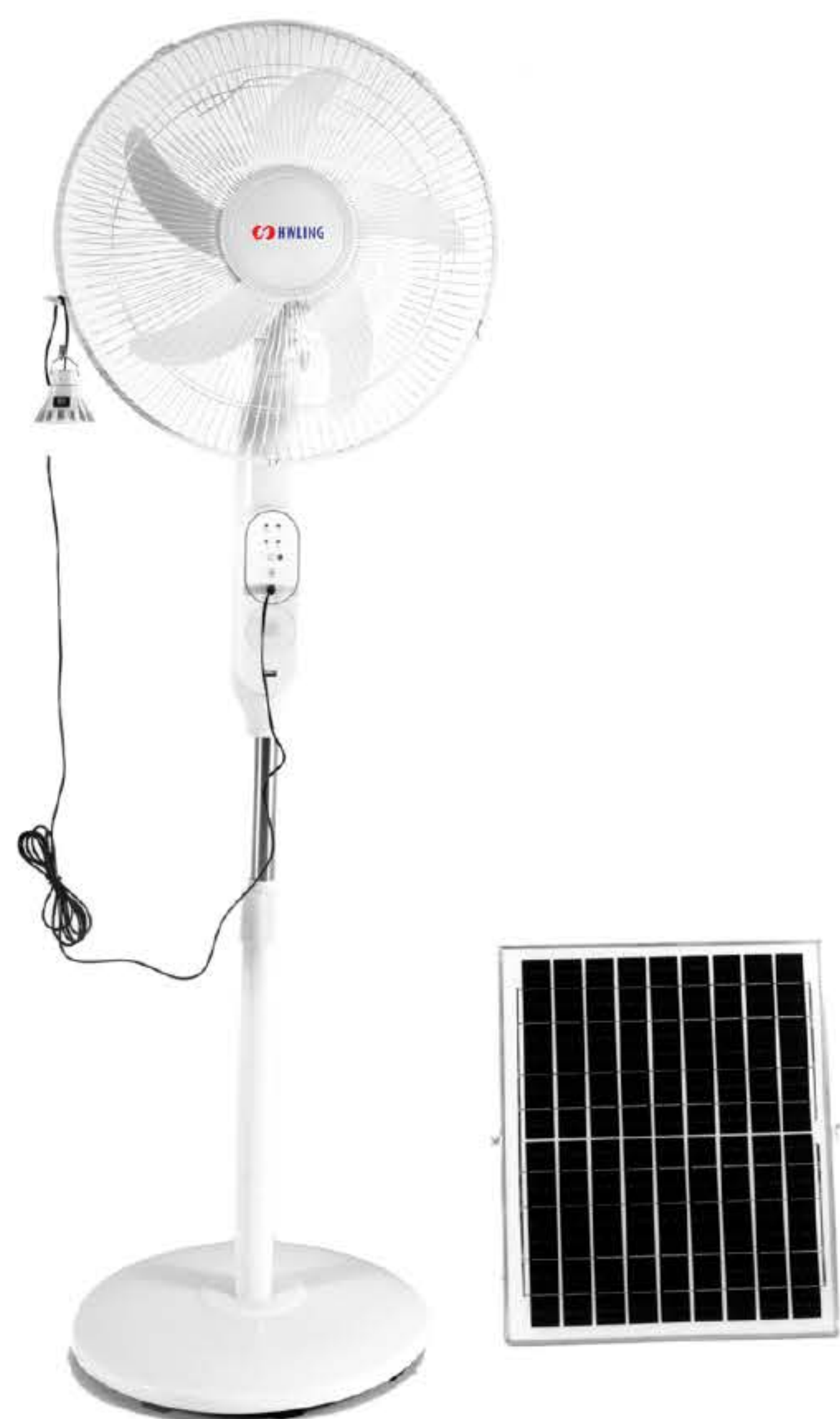

Technical Specifications

Output Power	25W
Battery capacity	Built-in Lithium battery (18000mah)
Rechargeable	By Adapter or Solar Panel
Charging Time	6H-10H (approx.)
Working Time	6H-20H(approx. depending on the speed settings)
Fan Speed	3 Speeds

Solar Fan

ASSEMBLING INSTRUCTIONS

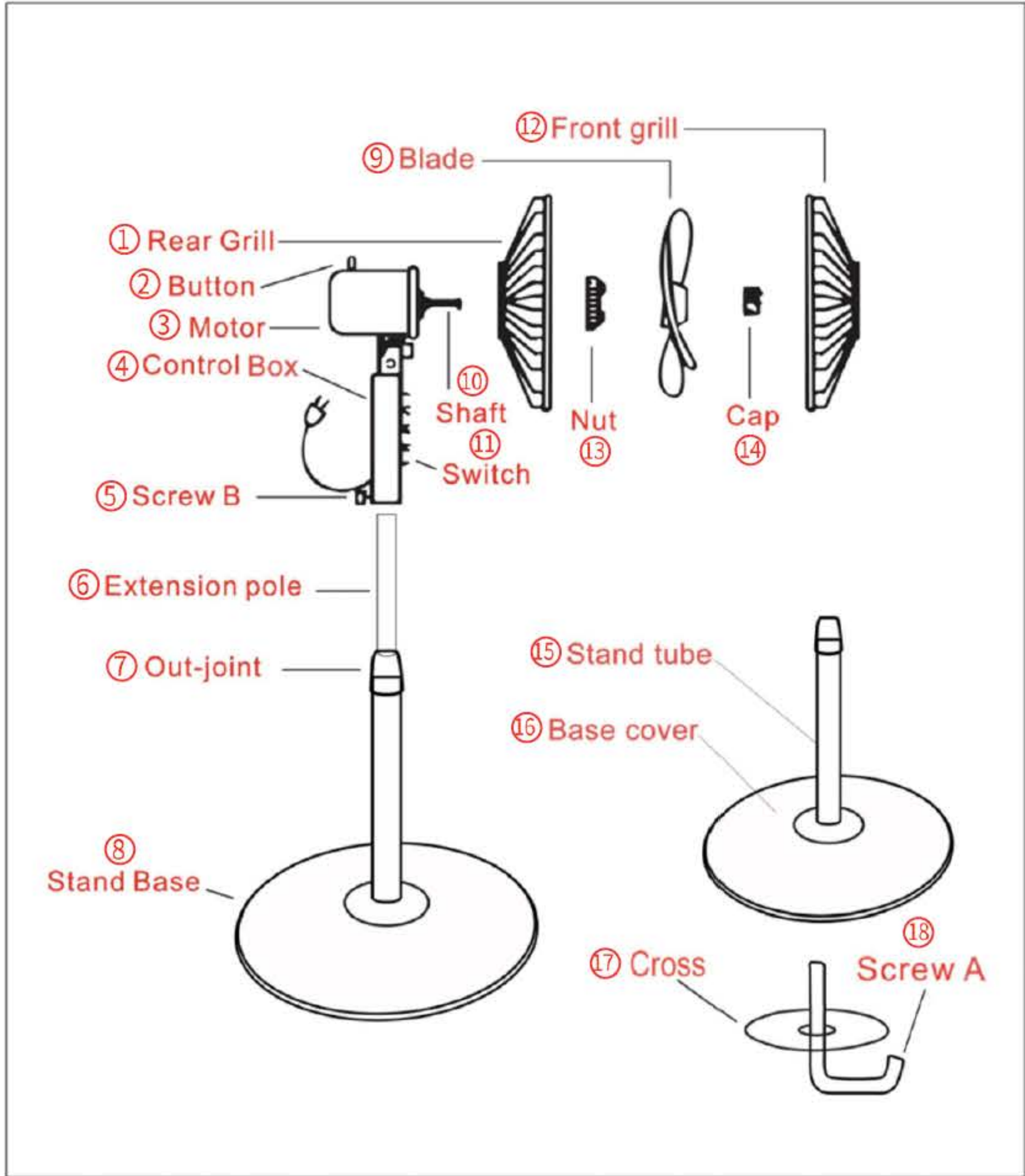

- 1 - Put stand tube from tube bottom on stand base and tighten to stand base with screw A.
- 2 - Unscrew out-joint completely. Put base cover on the stand base, pull the extension pole out and the tighten the out-joint again.
- 3- Place control box firmly on top of extension pole, tighten screw B

4- Unscrew the blade cap by turning clockwise & rear guard mounting nut by turning counter clockwise.

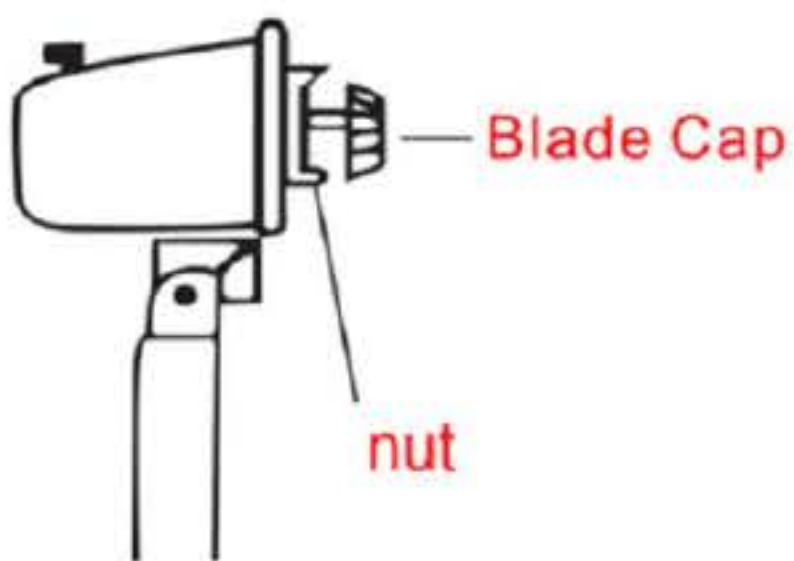

5- Put rear grill on motor shaft and secure with guard nut.

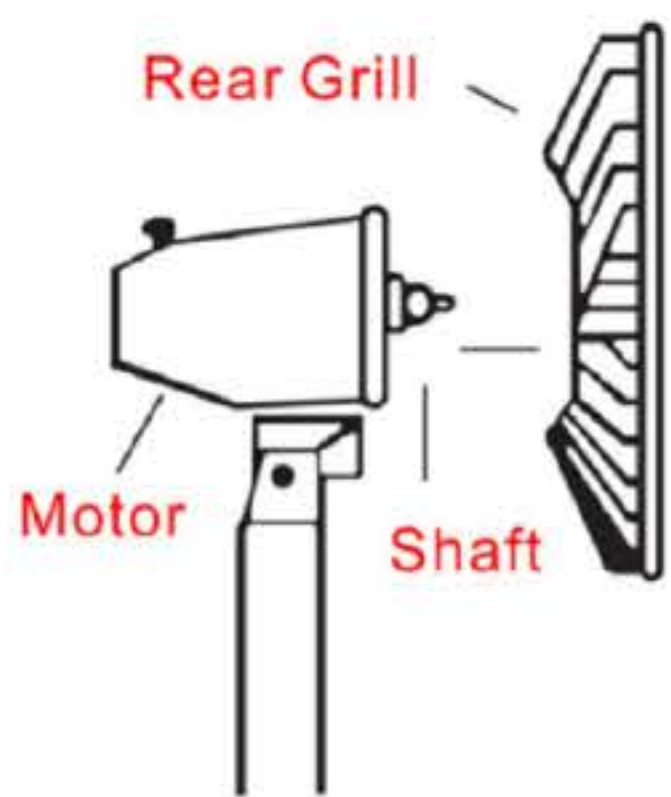

6- Slide blade on motor shaft.

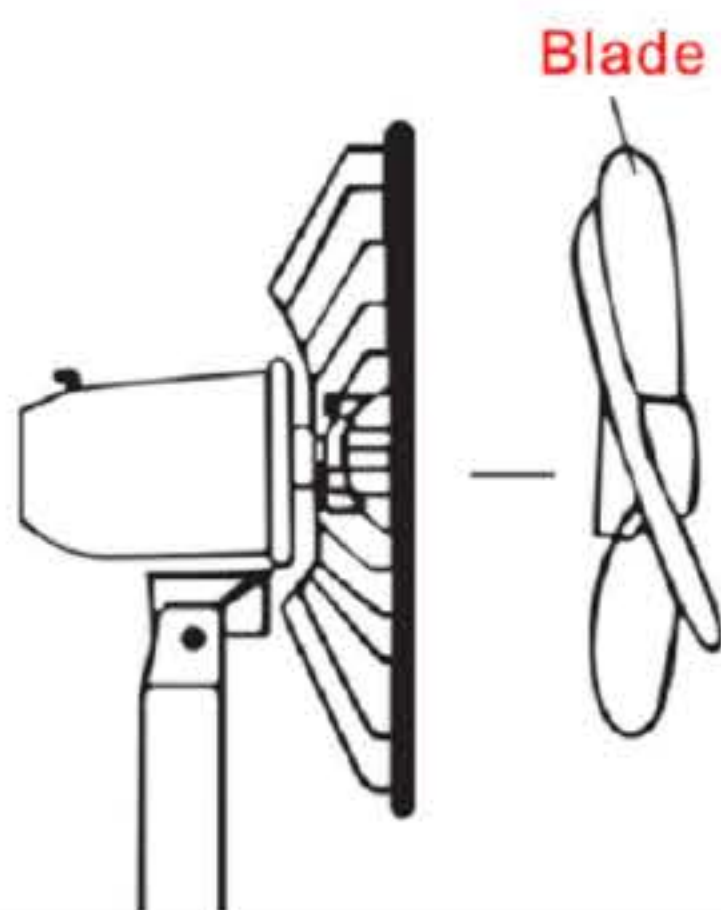

7- Screw blade cap on shaft by turning counter clockwise.

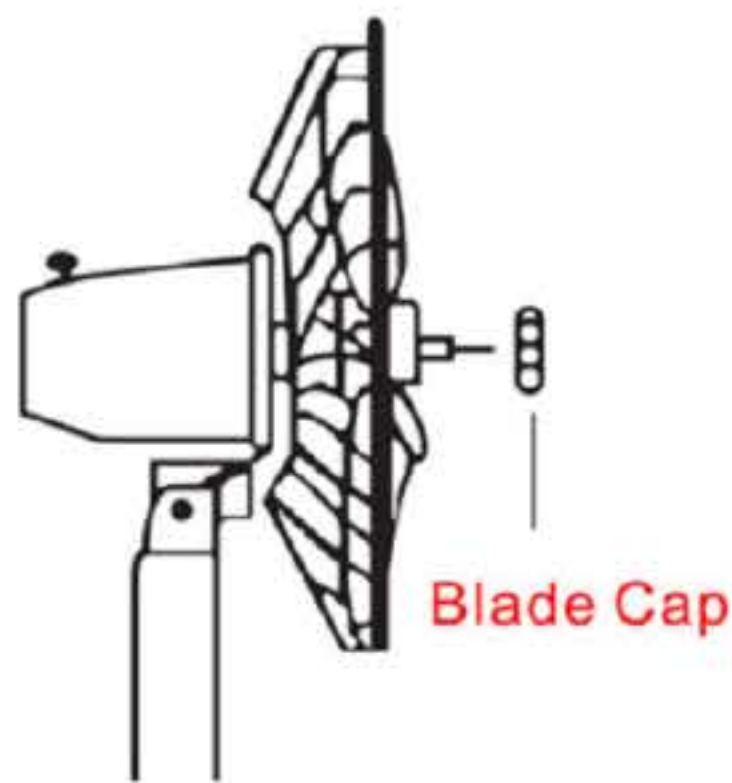

8- Put front grill on rear grill and close clips or screw grill ring to secure grill together.

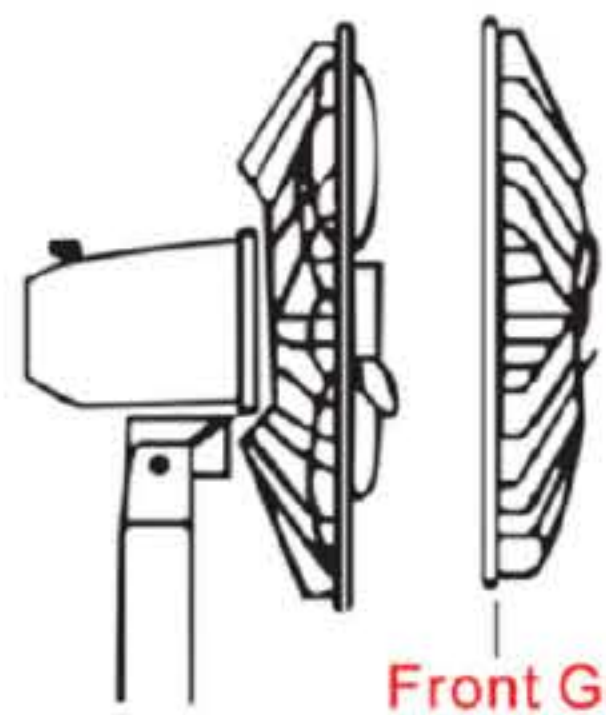

Description	BOM ID	QTY
Rear Grill	1	1
Button	2	1
Motor	3	1
Control Box	4	1
Screw B	5	1
Extension Pole	6	1
Out-Joint	7	1
Stand Base	8	1
Blade	9	1
Shaft	10	1
Switch	11	1
Front Grill	12	1
Nut	13	1
Cap	14	1
Stand Tube	15	1
Base Cover	16	1
Cross	17	1
Screw A	18	1